



# Southwire™

## COMPRESSION LUGS

### TWO HOLE - LONG BARREL

#### FEATURES

- Produced from high conductivity copper tubing and suitable for heavy duty applications
- Tin-plated to provide corrosion resistance
- Color coded

#### APPLICATIONS

- Listed for 35 KV maximum when properly installed
- Ideal for direct burial in earth or concrete and grounding applications

#### STANDARD MATERIAL

- Copper

#### STANDARD FINISH

- Tin plated



3201TZ

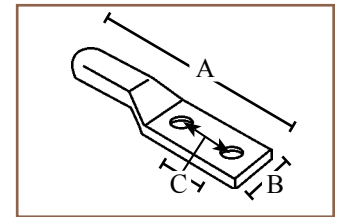

PART #	WIRE SIZE	COLOR CODE	BOLT SIZE	INNER QTY.	MASTER QTY.	WEIGHT/CASE (LBS.)	A	B	C = HOLE SPACING
3201TZ	#8	RED	1/4"	100	1000	23	2.19"	.42"	.625"
3202TZ	#6	BLUE	1/4"	100	1000	26	2.19"	.42"	.625"
3203	#4	GRAY	1/4"	100	1000	31	2.36"	.49"	.625"
3205TZ	#2	BROWN	1/2"	50	500	39	4.25"	.807"	1.75"
3206	1/0	PINK	1/2"	25	250	32	4.40"	.74"	1.75"
3207	2/0	BLACK	3/8"	25	250	34	4.61"	.81"	1.75"
3208	3/0	ORANGE	1/2"	20	200	33	4.69"	.90"	1.75"
3209	4/0	PURPLE	1/2"	10	100	21	4.72"	1"	1.75"
3209A	250 MCM	YELLOW	1/2"	10	100	27	4.95"	1.09"	1.75"
3209B	300 MCM	WHITE	1/2"	10	100	31	5.31"	1.19"	1.75"
3210	350 MCM	RED	1/2"	10	100	37	5.39"	1.28"	1.75"
3210A	400 MCM	BLUE	1/2"	5	50	23	5.47"	1.39"	1.75"
3211	500 MCM	BROWN	1/2"	5	50	32	5.79"	1.72"	1.75"
3211A	600 MCM	GREEN	1/2"	5	50	41	5.79"	1.72"	1.75"
3212	750 MCM	BLACK	1/2"	5	50	56	6.30"	1.90"	1.75"

Rev. 0, 10/23

**BUILT FOR DURABILITY.  
BUILT FOR RELIABILITY.  
BUILT FOR WORK.™**

1-855-798-6657 | SOUTHWIRE.COM

©2023 Southwire Company, LLC. All rights reserved.  
\*Registered Trademark & ™Trademark of Southwire Company, LLC.