

Drop bracket clamp for steady arms, complete, 1 steady arm, to pipe 2.0"

Item number D3124-02

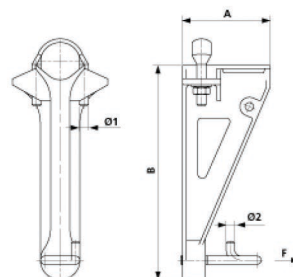

Dimensions

B: 285 mm

A: 115 mm

Ø1: M12

Ø2: 10.900 mm

Material and weight

Weight: 1.120 kg

Material: Al/SST

Loads

Breaking load F: 5.6 kN



Southwire™



A COLAS RAIL COMPANY

Contact Us: Transit@southwire.com