

SIDES	BOTTOM
Material:Steel-(C1008-C1018) Galvanized	

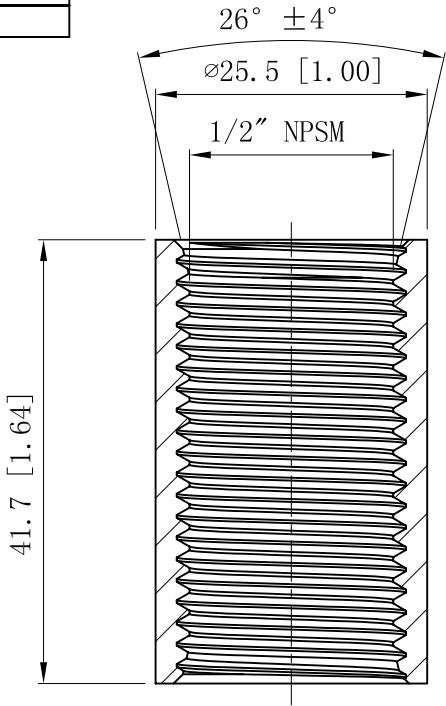

CUTAWAY VIEW A-A

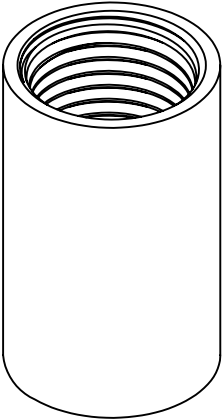
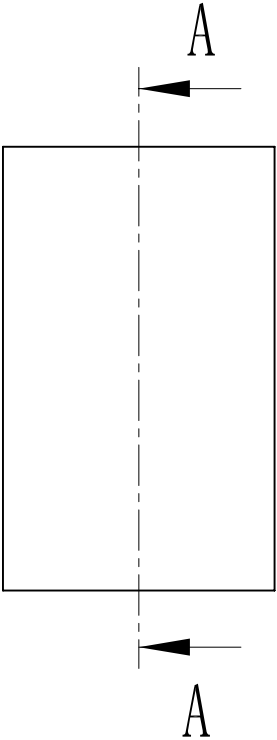

DESCRIPTION
TRADE REFERENCE TERMS

This data sheet is for reference only .GARVIN INDUSTRIES reserves the right to make changes to the design without prior notice.

STANDARD PACKING	GARVIN INDUSTRIES		
	TITLE THREADED RIGID COUPLING		
	100 PCS	SIZE A4	DWG NO. RC-50
DATA SHEET			
			REV B