

SIDES	BOTTOM
1 PCS 10-32×1/2 Screws Installed	
Material:Steel-0.0625"-C.R.S Zinc Plated	

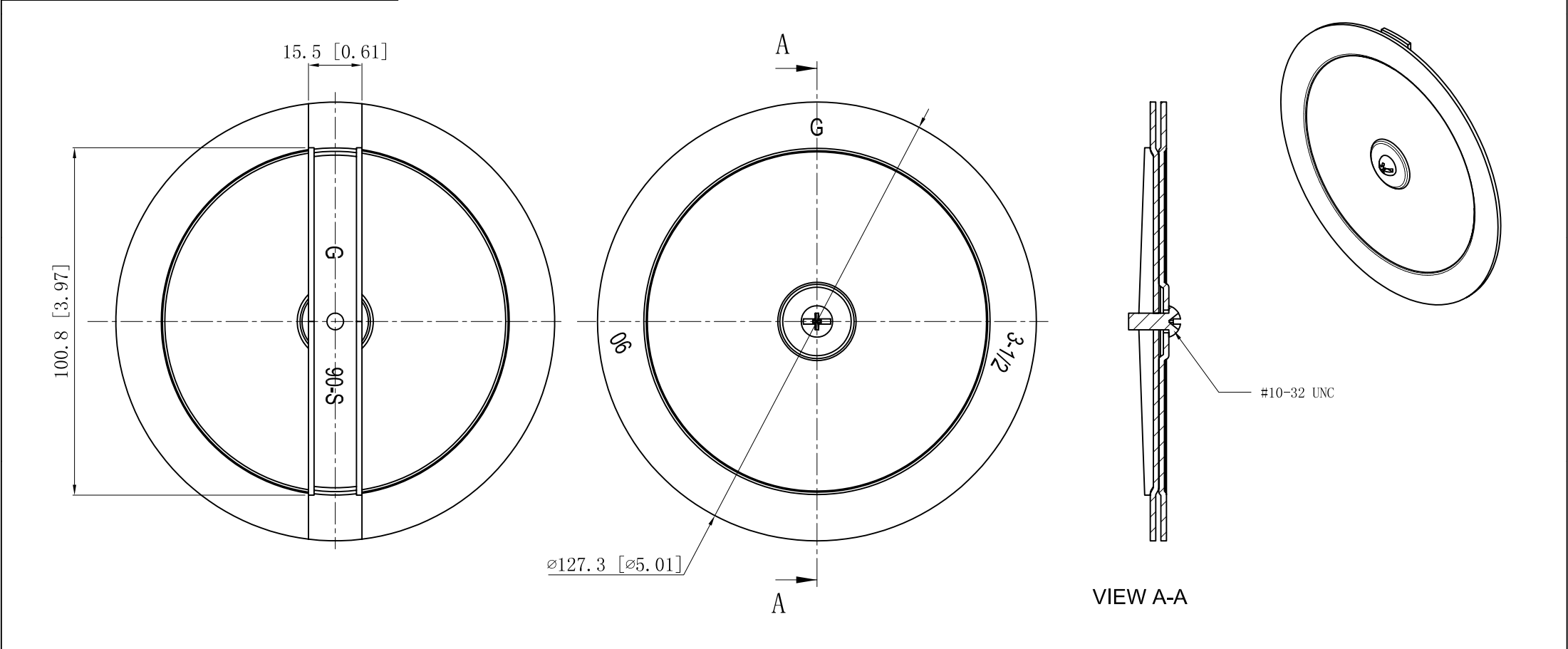

DESCRIPTION
TRADE REFERENCE TERMS

This data sheet is for reference only .GARVIN INDUSTRIES reserves the right to make changes to the design without prior notice.

STANDARD PACKING	GARVIN INDUSTRIES		
10 PCS	TITLE		
	KNOCKOUT SEALS		
	SIZE	DWG NO.	REV
	A4	KOS-350	
	DATA SHEET		