

Insulator with clevis eye and tongue complete, composite, $\varnothing = 80$ mm

Item number E3301-01

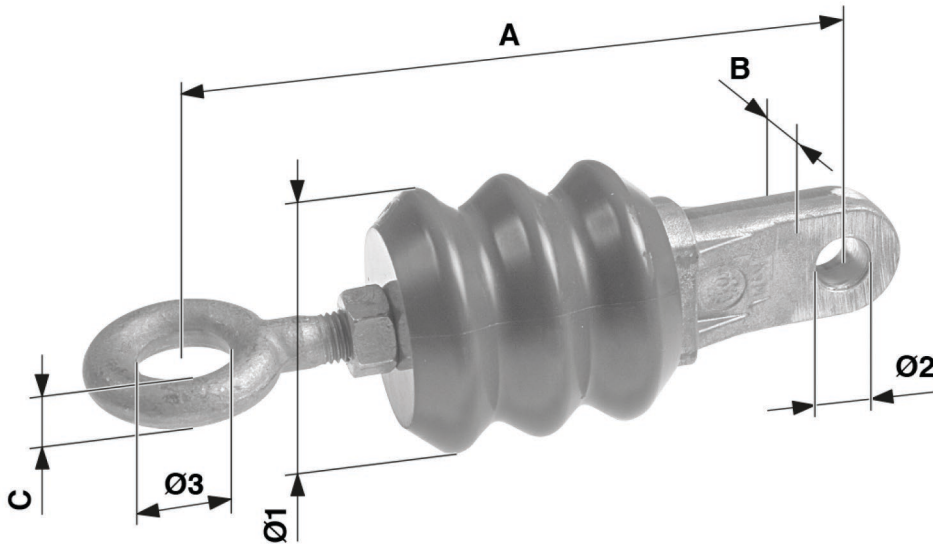

Dimensions

A: 200 mm

B: 18 mm

Ø2: 17 mm

Ø1: 80 mm

C: 14.5 mm

Ø3: 27 mm

Material and weight

Weight: 1.140 kg

Loads

Breaking load: 30 kN

Specification

Operating voltage: max. 3.000 kV

Minimum creeping distance: 120 mm

Comments

- Connection parts in Al/STL HDG



Southwire™



A COLAS RAIL COMPANY

Contact Us: Transit@southwire.com