

SIDES	BOTTOM
8 1" KNOCKOUTS	3 1/2" KNOCKOUTS
	2 3/4" KNOCKOUTS
Material: Steel-0.0625"-G60 Galvanized	

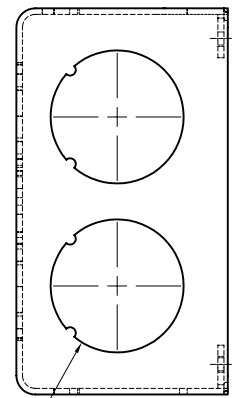

4 1" KNOCKOUTS $\phi=35.00$ [$\phi=1.378$]

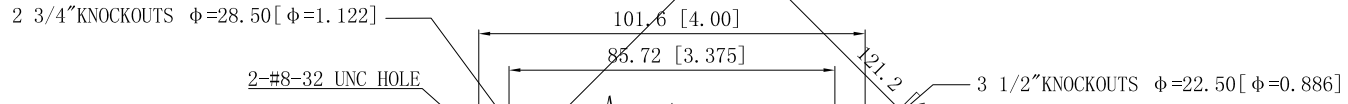
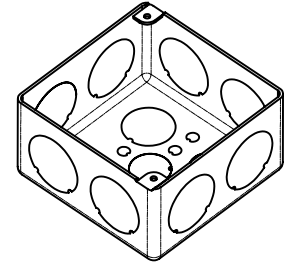
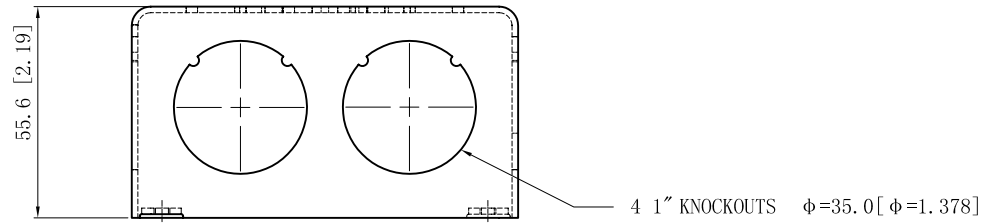
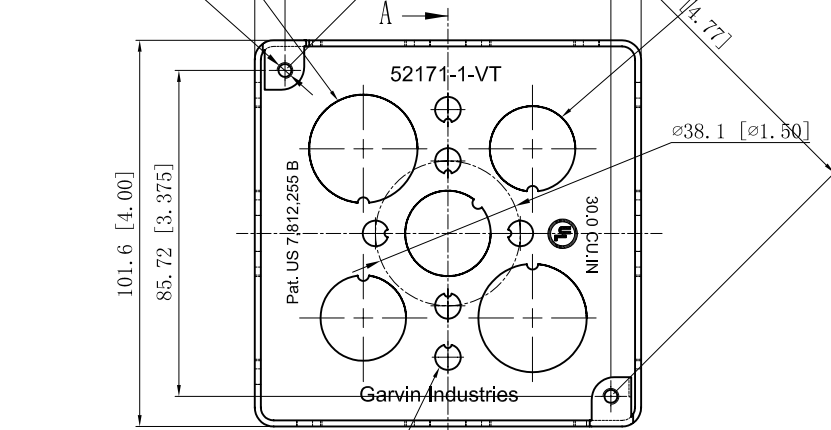

6 KNOCKOUTS $\phi=6.75$ [$\phi=0.27$]

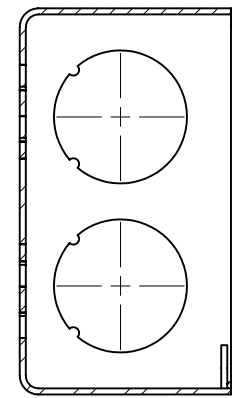

CUTAWAY VIEW A-A

DESCRIPTION
Patent #: Pat. US 7,812,255 B
TRADE REFERENCE TERMS

STANDARD PACKING
25 PCS

This data sheet is for reference only. GARVIN INDUSTRIES reserves the right to make changes to the design without prior notice.

GARVIN INDUSTRIES		
TITLE 4" SQUARE BOXES 2-1/8" DEEP		
SIZE A4	DWG NO. 52171-1-VT	REV H
DATA SHEET		