

SIDES	BOTTOM
Material:Steel-(C1008-C1018) Galvanized	

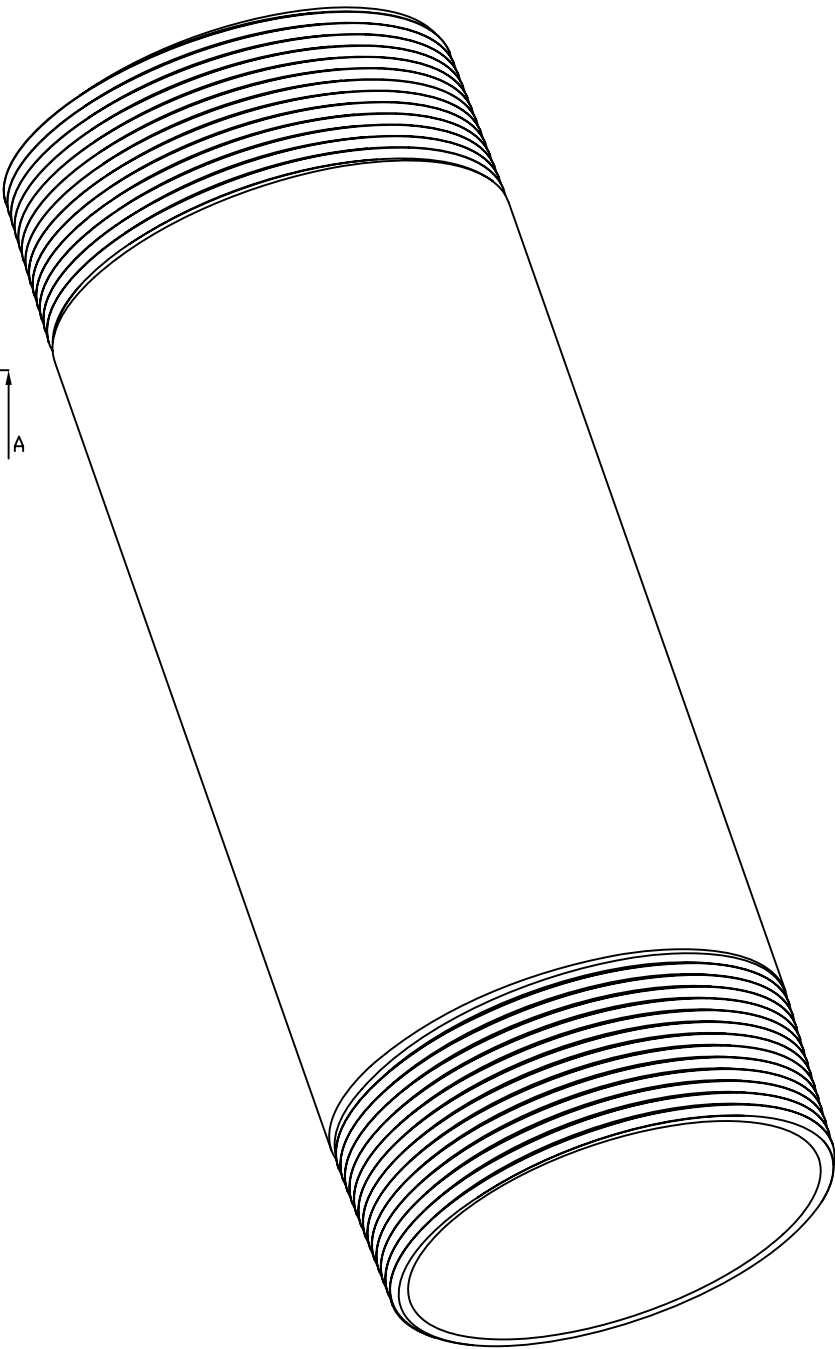
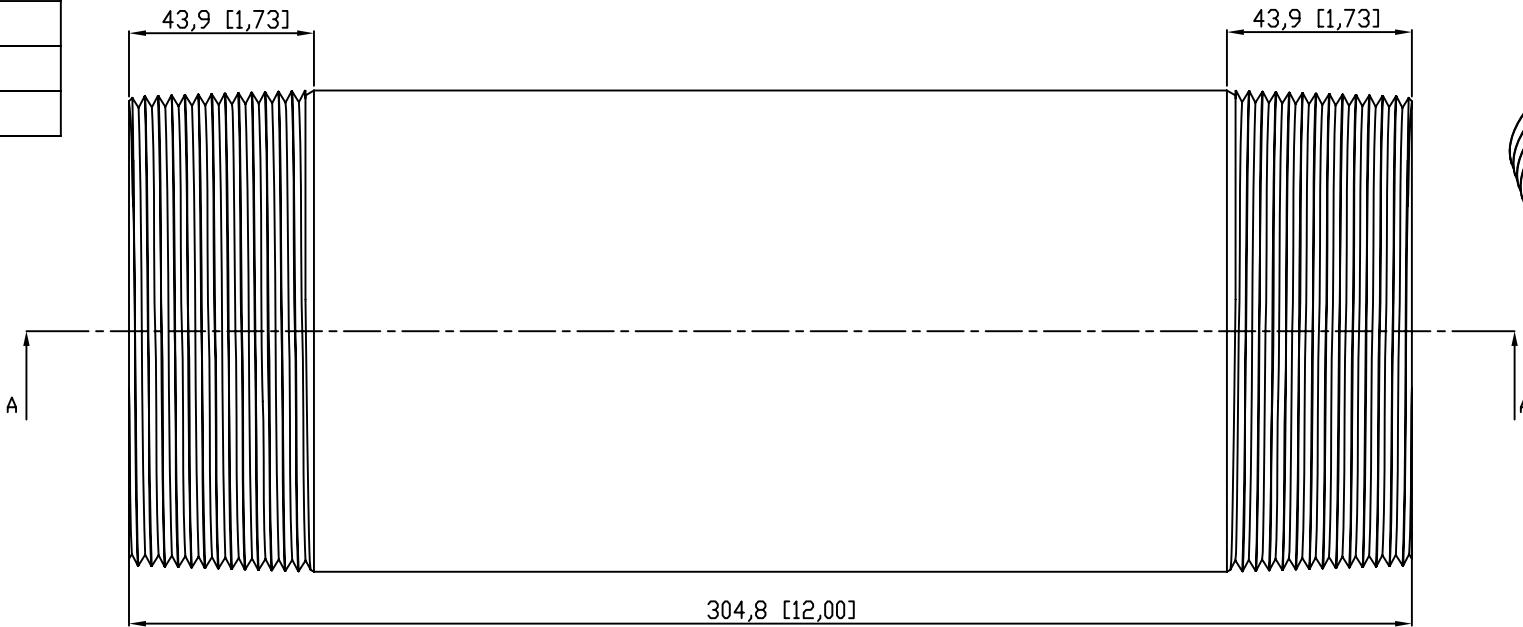

VIEW A-A

This data sheet is for reference only .GARVIN INDUSTRIES reserves the right to make changes to the design without prior notice.

DESCRIPTION		the right to make changes to the design without prior notice.		
		STANDARD PACKING	GARVIN INDUSTRIES	
			TITLE RIGID COND NIPPLE	
			SIZE A4	DWG NO. DS-RN-4001200
TRADE REFERENCE TERMS				