

Messenger cable suspension insulated, rotatable, inverted, reinforced, to pipe 2", cable Ø max. 21 mm

Item number D2760-01

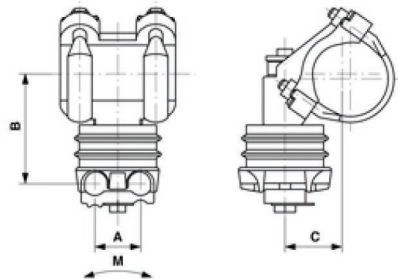

Dimensions

A: 49 mm

C: 61.8 mm

B: 119 mm

Material and weight

Material: Al/SST/Synth.

Loads

Breaking moment M: 1680 Nm

Specification

Operating voltage: max. 1500 V DC, max. 1000 V AC

Comments

- The installation side of the messenger cable has to be selected so that the lateral force cause by the curve pull act in direction of the cap screw
- For cable diameter
- Ø= 10-16 mm and 21 mm
- Use for other cable diameter on request
- Additional messenger cable suspensions for 3000 V DC on request



Southwire™



A COLAS RAIL COMPANY

Contact Us: Transit@southwire.com