

SIDES	BOTTOM
8 3/4" KNOCKOUTS	
2 PCS 8-32×1/2 Screws Installed	
Material: Steel-0.0625"-G60 Galvanized	

12 PLACES SPOT WELDING

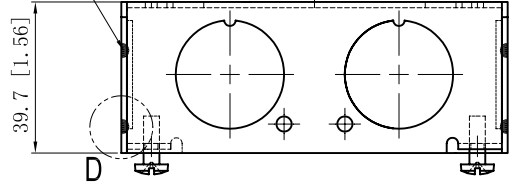

#8-32, ×2

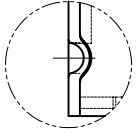
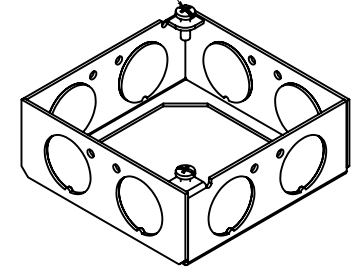

WELDING STYLE DETAIL VIEW D

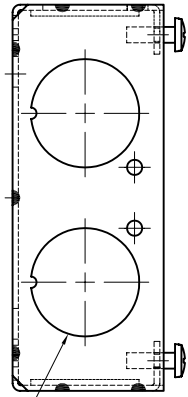

8 3/4" KNOCKOUTS $\phi=28.50$ [$\phi=1.122$] MIRROR

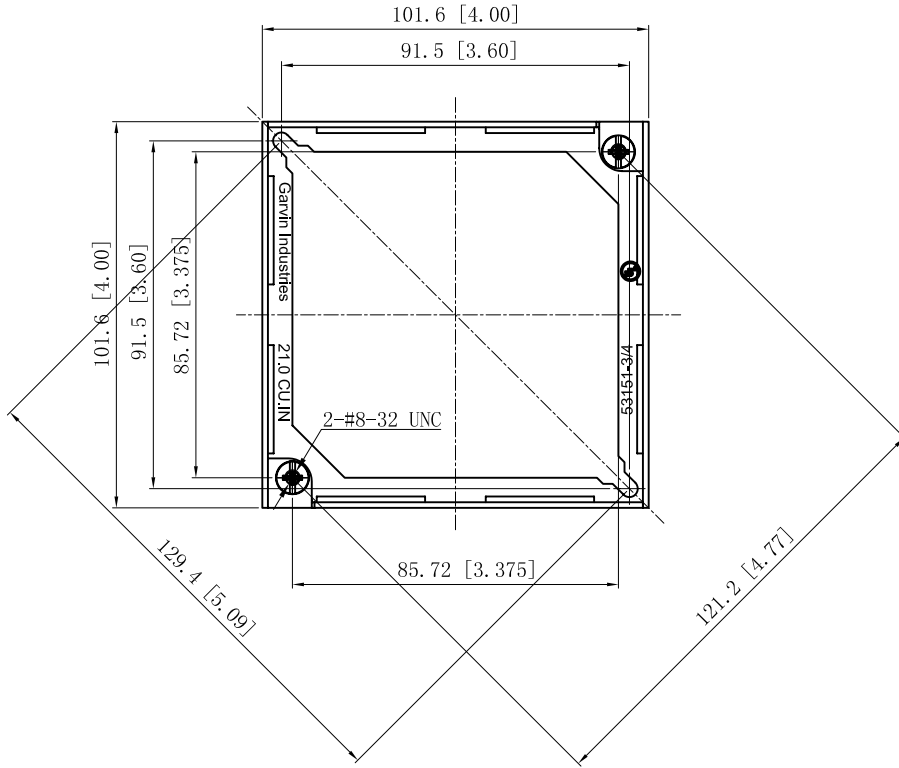

DESCRIPTION
TRADE REFERENCE TERMS

This data sheet is for reference only. GARVIN INDUSTRIES reserves the right to make changes to the design without prior notice.

STANDARD PACKING	GARVIN INDUSTRIES		
	4" SQUARE EXTENSION RINGS 1-1/2" DEEP		
50 PCS	TITLE	53151-3/4	
	SIZE	DWG NO.	REV
	A4		C
DATA SHEET			