

SIDES	BOTTOM
2 PCS 6-18X2 Coarse drywal Screws Pack In Poly-bag	
Material:Steel-0.0303MIN"-G60 Galvanized	

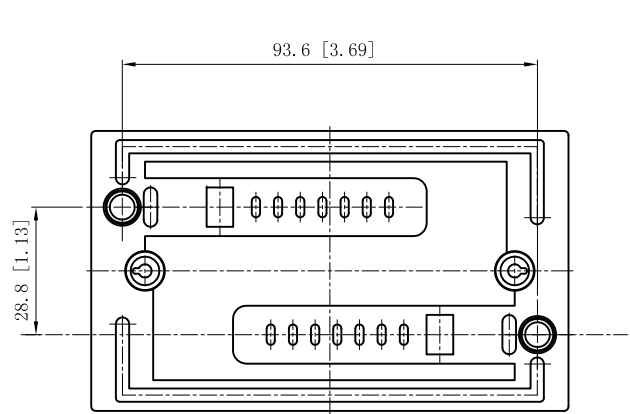

VIEW E

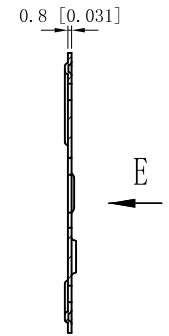

CUTAWAY VIEW C-C

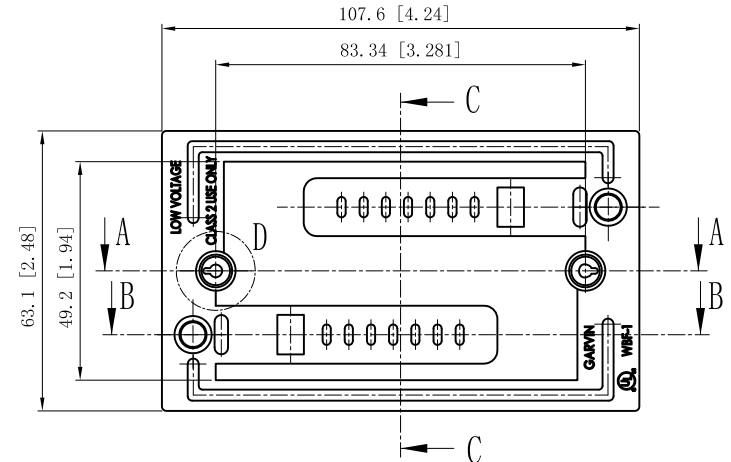

CUTAWAY VIEW A-A

CUTAWAY VIEW B-B

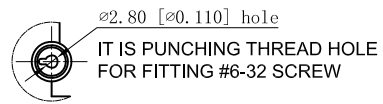
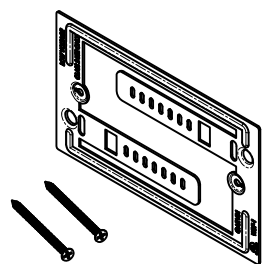

VIEW D

This data sheet is for reference only .GARVIN INDUSTRIES reserves the right to make changes to the design without prior notice.

DESCRIPTION
TRADE REFERENCE TERMS

STANDARD PACKING
100 PCS

TITLE		GARVIN INDUSTRIES	
BOX ELIMINATOR 1-GAN			
SIZE	DWG NO.		
A4		WBF-1	REV B
DATA SHEET			