

LED ECONOMY WALL PACK INSTALLATION INSTRUCTIONS

READ AND FOLLOW ALL SAFETY INSTRUCTIONS!



WARNING

- Make all electrical and grounded connections in accordance with local codes or the National Electrical Code. If you are not familiar with these codes and requirements, consult a qualified electrician. This professional should be familiar with the construction and operation of this product and hazards involved. Failure to do so may result in serious personal injury.
- To reduce the risk of fire, electric shock, personal injury, or property damage, please read and follow all safety instructions. If you do not understand these instructions or if any additional information is required, contact your local Topaz representative. Retain these instructions for maintenance reference.
- Make certain electrical supply is OFF before energizing fixture.
- Do not exceed the allowed supply voltage marked on the luminaire label information.



CAUTION

- Do not expose wires to any sharp objects such as sheet metal to prevent wiring damage or abrasion.
- To avoid risk of burn, be sure fixture temperature is cool enough to touch before handling.
- While the light is on, please avoid direct eye exposure.
- Combustible materials should be kept away from fixture/lens.

LED ECONOMY WALL PACK INSTALLATION INSTRUCTIONS

ELECTRICAL PARAMETERS

Model No.	Input Voltage	Frequency	Power	Rated Current
F-WPE/60W/50K/BZ/PC	120-277V	50/60Hz	60W	0.6A
F-WPE/120W/50K/BZ/PC	120-277V	50/60Hz	120W	1.2A

INSTALLATION STEPS

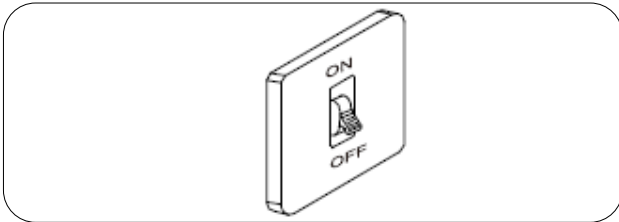

Turn off Power at circuit breaker box.

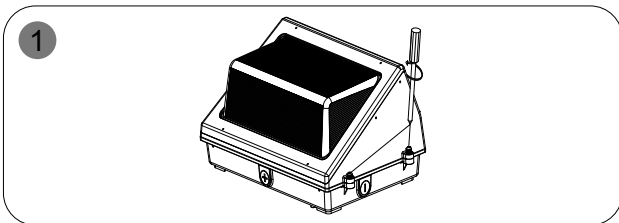

1.Remove the Door Assembly (2) by loosening the two screws located on the side of the fixture.

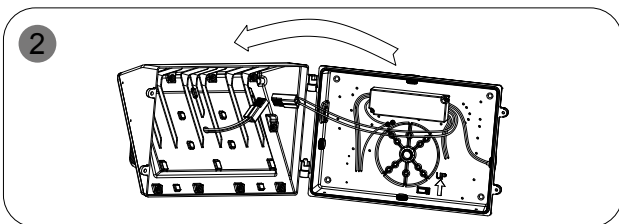

2.Open the fixture and disconnect the orange connector and remove the front cover of the fixture.

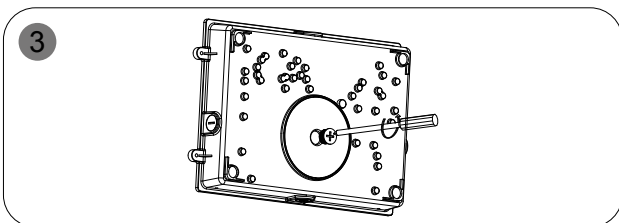

3.Remove the center knockout with screwdriver.

LED ECONOMY WALL PACK INSTALLATION INSTRUCTIONS

4

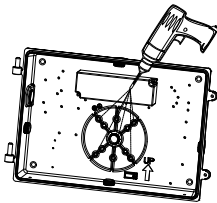

4. Drill out appropriate mounting hole knock outs located on the rear housing. Use the mounting holes for surface or junction box mounting.

5

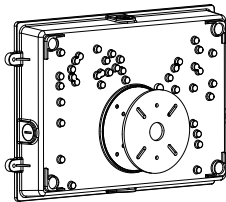

5. Attached circular gasket to the back of the fixture.

6

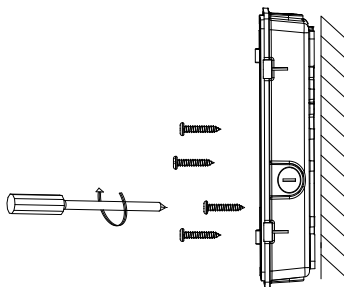

6. Align the back housing correctly and secure the rear housing to the wall. Note: Assure that fixture is mounted onto a structurally sound surface and use mounting hardware appropriate for your application. For Wet Location compliance, fixture must be properly sealed! For moisture seal apply silicone caulking between the mounting surface and rear housing as well as around sides of rear housing.

7

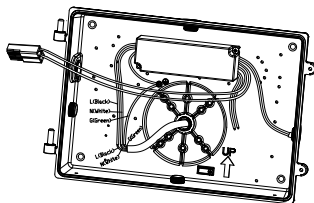

7. Connect fixture leads to supply leads by using the wiring diagram.

8

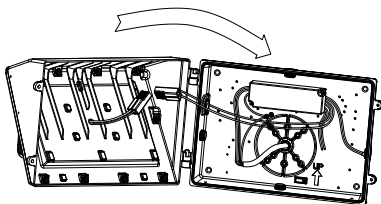

8. Replace front cover. Make sure that the lens gasket is properly seated around the perimeter of the cover to insure a weathertight seal.

LED ECONOMY WALL PACK INSTALLATION INSTRUCTIONS

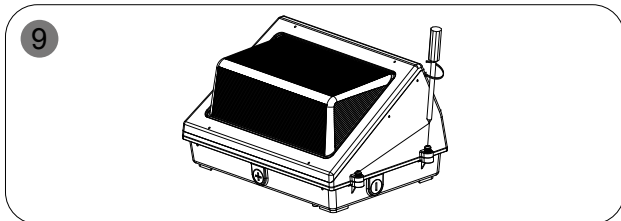

9. Fix the fixture with screws.

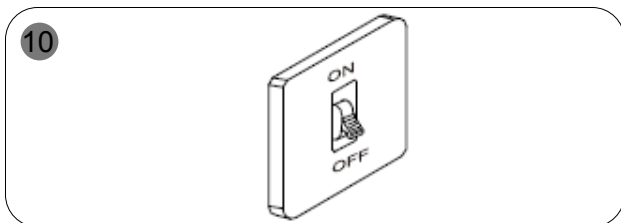

10. Make sure the installation is complete before turning on the power switch.

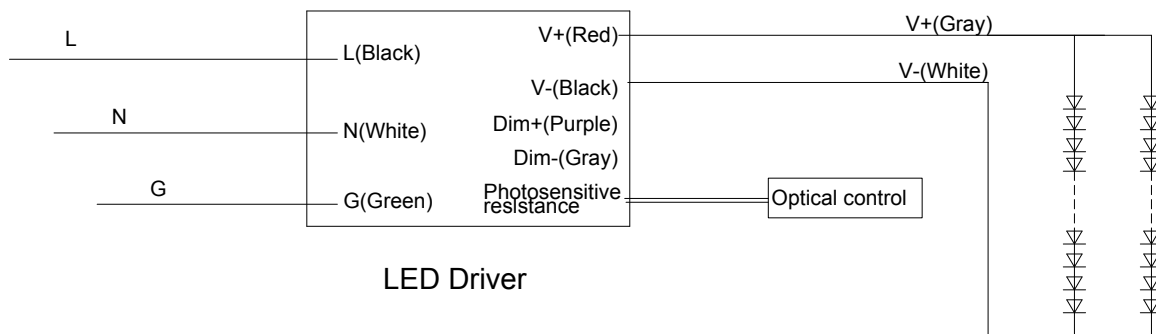

Note: If not required, simply disconnect plug from back of photocell.

1. Connect the black fixture lead to the black supply lead.
2. Connect the white fixture lead to the white supply lead.
3. Connect the green fixture lead to the green supply lead.
4. Do not route wires between ballast and reflector.

Failure to follow any of these instructions could void product warranties. For a complete listing of product Terms and Conditions, please visit www.topaz-usa.com/led-fixtures-warranty