

SIDES	BOTTOM
Material:Steel-(0.104"-0.110")-Galvanized or C.R.S and zinc plated	

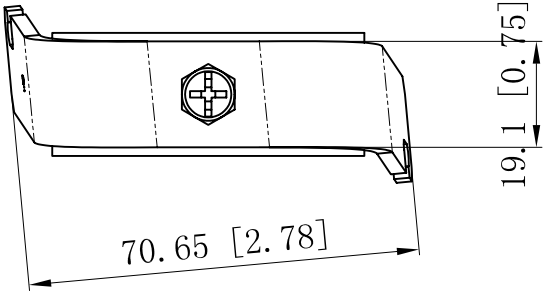

#1/4-20 UNC

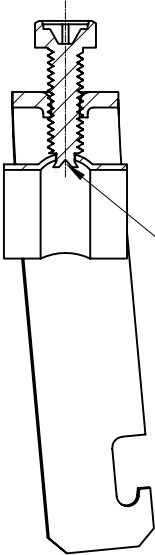
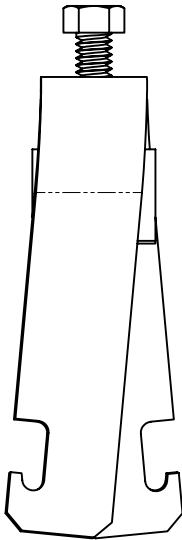
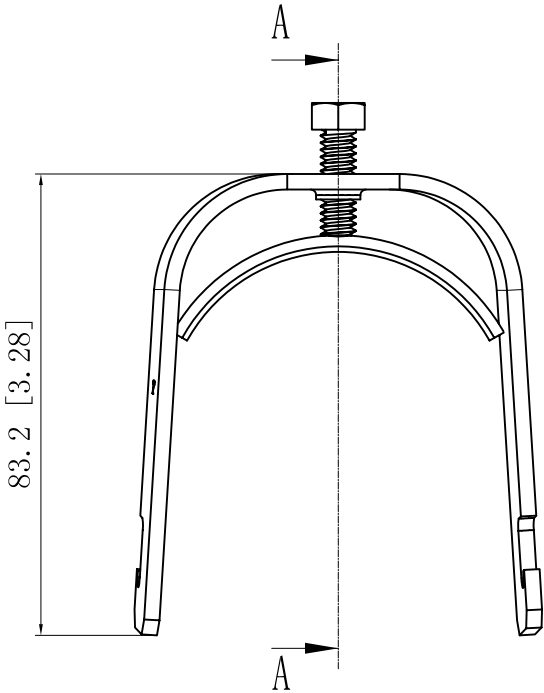
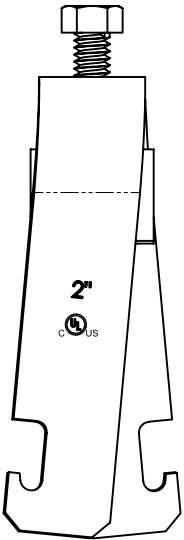
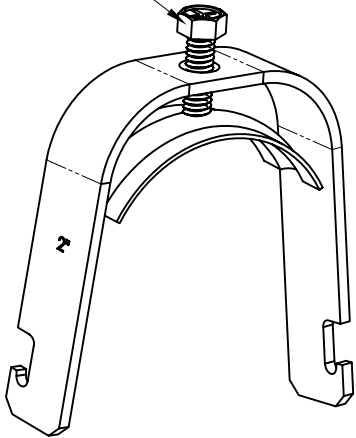

SWEDGE

CUTAWAY VIEW A-A

DESCRIPTION
TRADE REFERENCE TERMS

This data sheet is for reference only .GARVIN INDUSTRIES reserves the right to make changes to the design without prior notice.

STANDARD PACKING		GARVIN INDUSTRIES		
25 PCS	TITLE			
	ONE-PIECE STRUT CLAMPS			
	SIZE	DWG NO.		REV
	A4	OPSC-200		A
DATA SHEET				