

**Pipe connector with tongue, complete, to pipe 2" Schedule 80**  
Part no. D2744-02

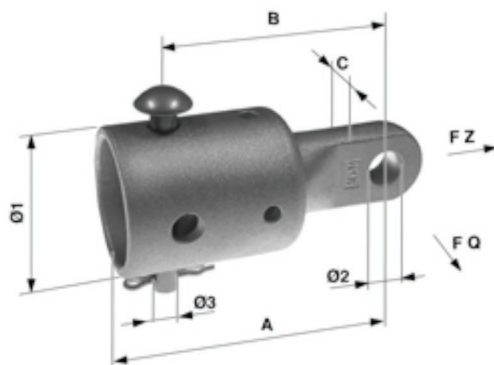

**Technical data**

Dimensions

A: 140 mm  
B: 115 mm  
C: 18 mm  
Ø1: 48.0 mm  
Ø2: 17 mm  
Ø3: 12 mm

Material and weight

Material: Al/SST

Loads and tightening torque

Breaking load F across: 15 kN  
Breaking load F on traction: 38 kN

Standards applied

-

Function

-

Specifications

-

Spare parts

Tongue, with thread M16, Part no. D2357-01  
Pin, 12 x 80, Part no. E3232-03  
Cotter pin, 4.0 x 30, Part no. E3234-01

Accessories

-

Comments

- The pipe connector G2" and additionally the distance bushing part no. E 3259-01 must be used for pipe G2.5" w/reinforced wall  
- Other pole diameter on request



**Southwire™**



A COLAS RAIL COMPANY

Contact Us: [Transit@southwire.com](mailto:Transit@southwire.com)