

SIDES	BOTTOM
Material: Steel-(C1008-C1018) Galvanized	

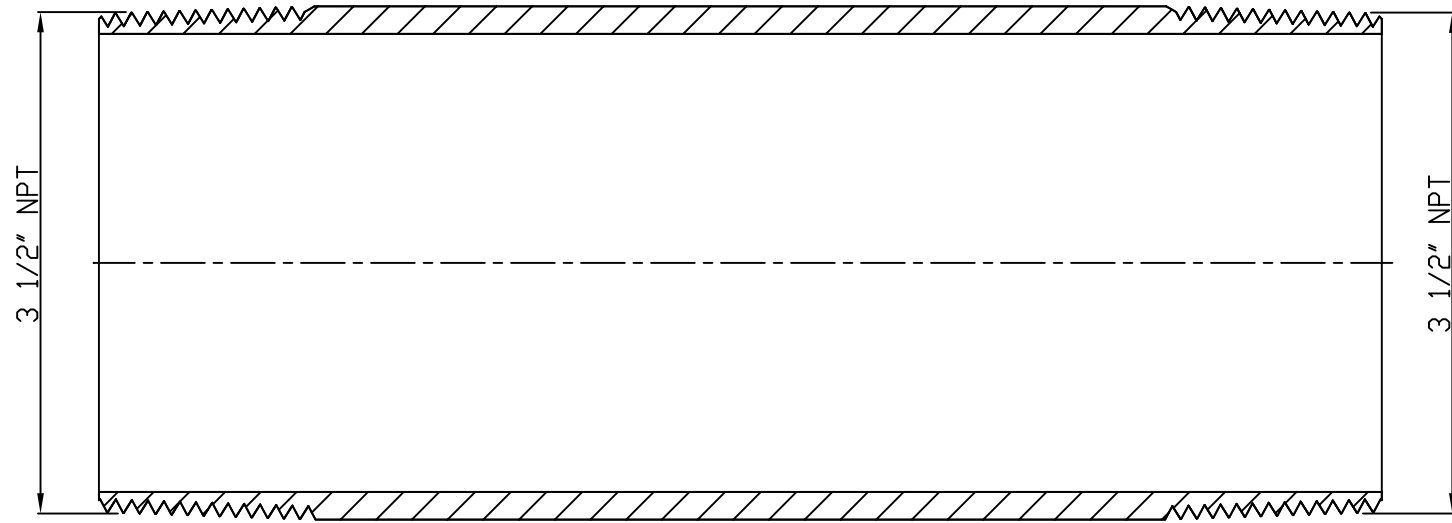

VIEW A-A

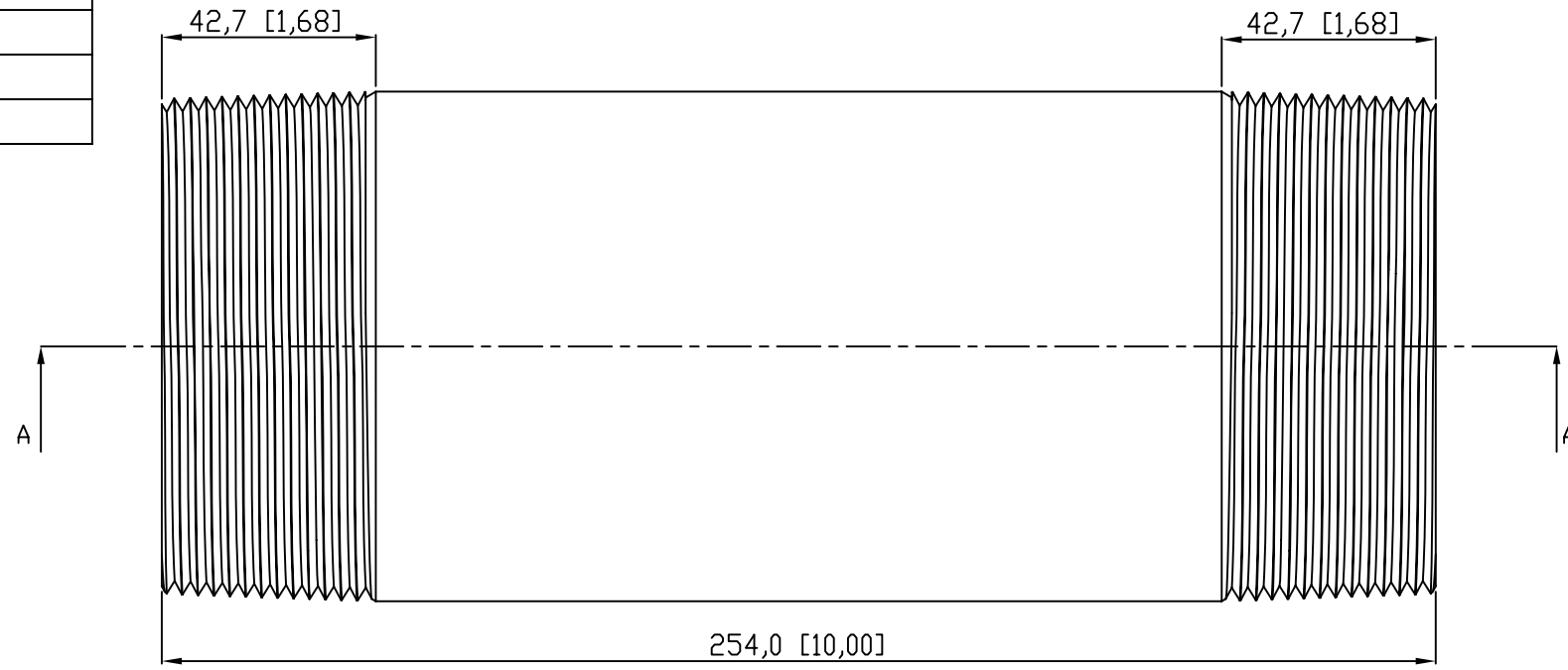
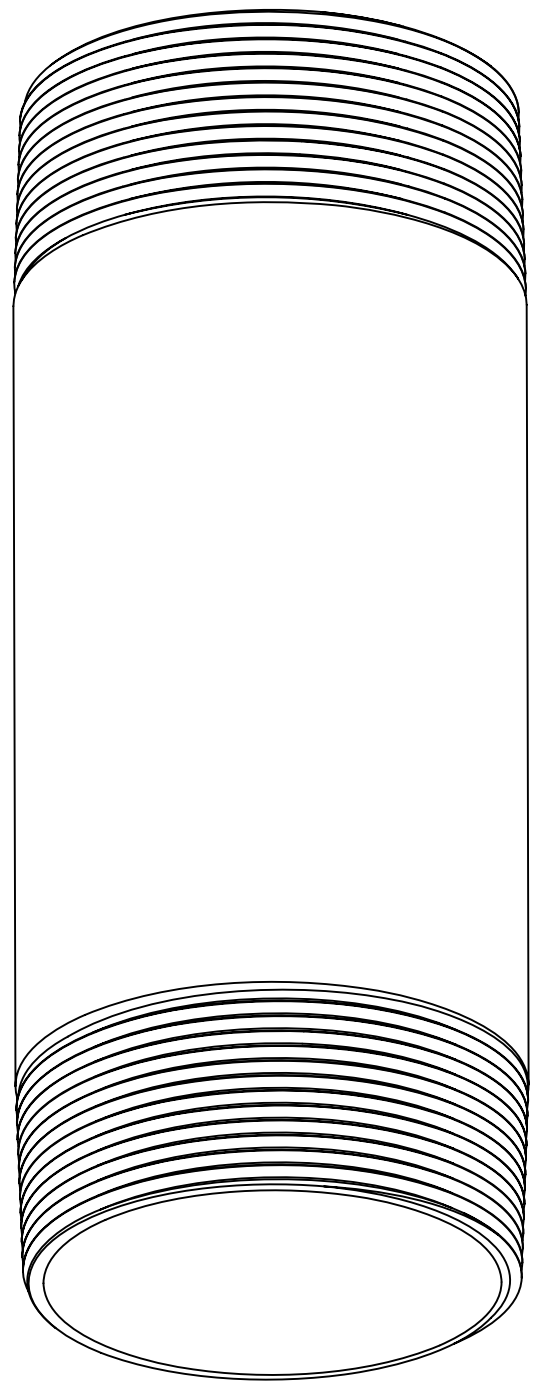

This data sheet is for reference only .GARVIN INDUSTRIES reserves the right to make changes to the design without prior notice.

DESCRIPTION
TRADE REFERENCE TERMS

STANDARD PACKING	GARVIN INDUSTRIES		
	TITLE RIGID COND NIPPLE		
	SIZE A4	DWG NO. DS-RN-3501000	REV A