

| | |
|---|--------|
| SIDES | BOTTOM |
| | |
| | |
| | |
| 2 PCS 8-32×1/2 Screws Installed | |
| Material:0.051~0.059"-Stainless steel 316 | |

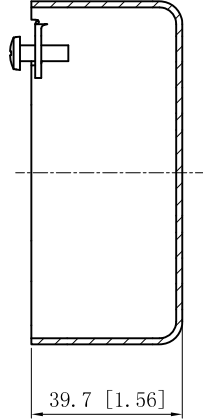

CUTAWAY VIEW A-A

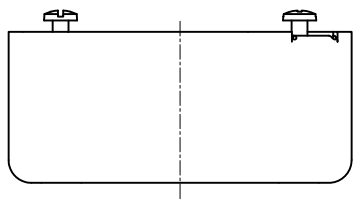
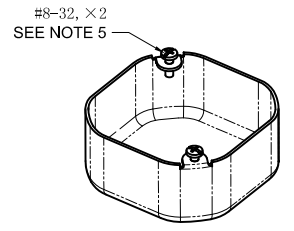
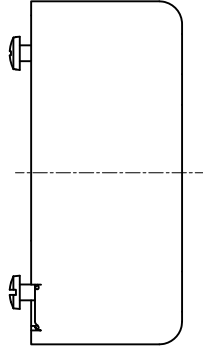
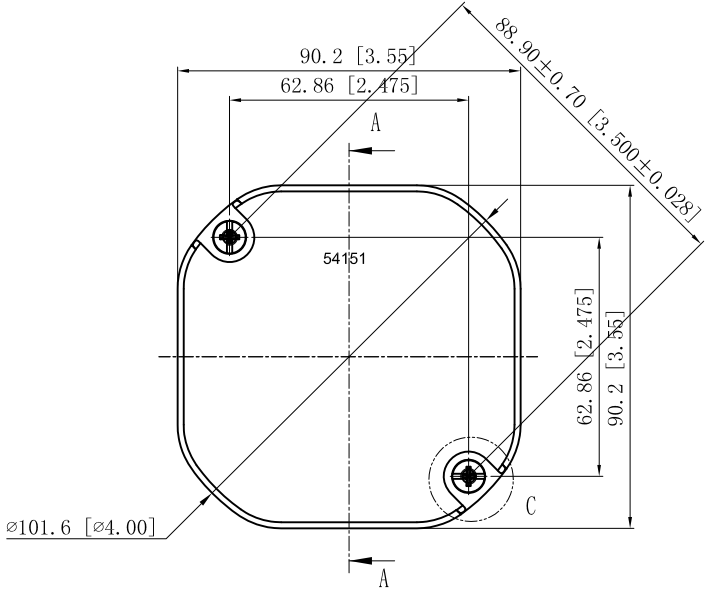

This data sheet is for reference only.GARVIN INDUSTRIES reserves the right to make changes to the design without prior notice.

| |
|-----------------------|
| DESCRIPTION |
| |
| |
| TRADE REFERENCE TERMS |
| |

| |
|------------------|
| STANDARD PACKING |
| 50 PCS |

| | | |
|---|-------------------------|-----|
| GARVIN INDUSTRIES | | |
| TITLE 4"OCTAGON"CHICAGO PLENUM"BOXES | | |
| SIZE A4 | DWG NO. 54151-BLNKSS | REV |
| DATA SHEET | | |
| www.garvinindustries.com | | |