

SIDES	BOTTOM
Material:Steel-0.0625"-#3 ZAMAK Zinc Plated	

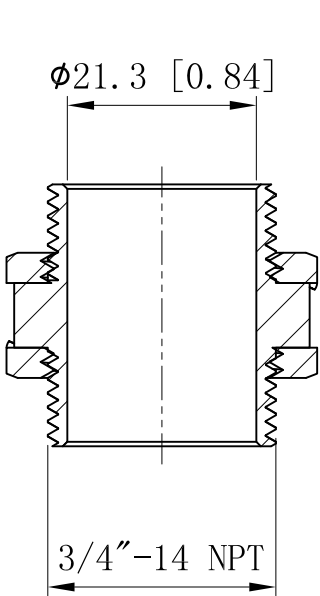

CUTAWAY VIEW A-A

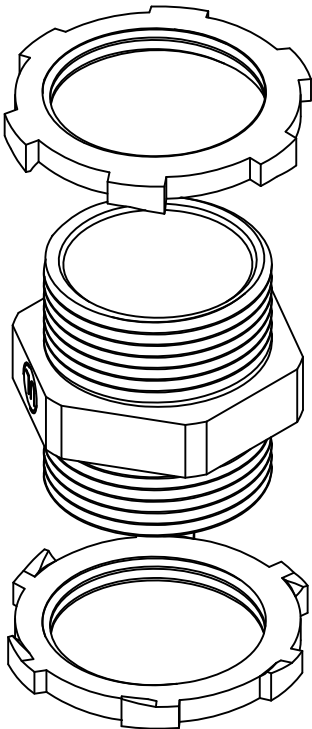
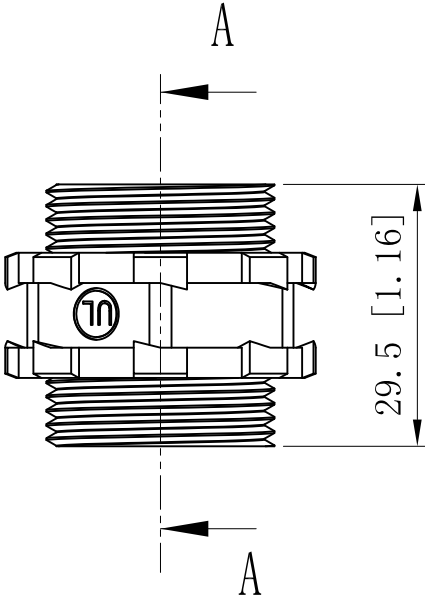

DESCRIPTION
TRADE REFERENCE TERMS

This data sheet is for reference only .GARVIN INDUSTRIES reserves the right to make changes to the design without prior notice.

STANDARD PACKING	GARVIN INDUSTRIES		
50/500 PCS	TITLE BACK-TO-BACK CONNECTOR		
	SIZE A4	DWG NO. BB-3/4	REV C
	DATA SHEET		