

SIDES	BOTTOM
Material: Steel- $\phi 0.205$ " C1008-C1018 Zinc Plated	

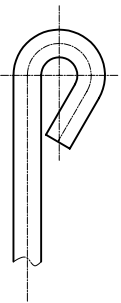
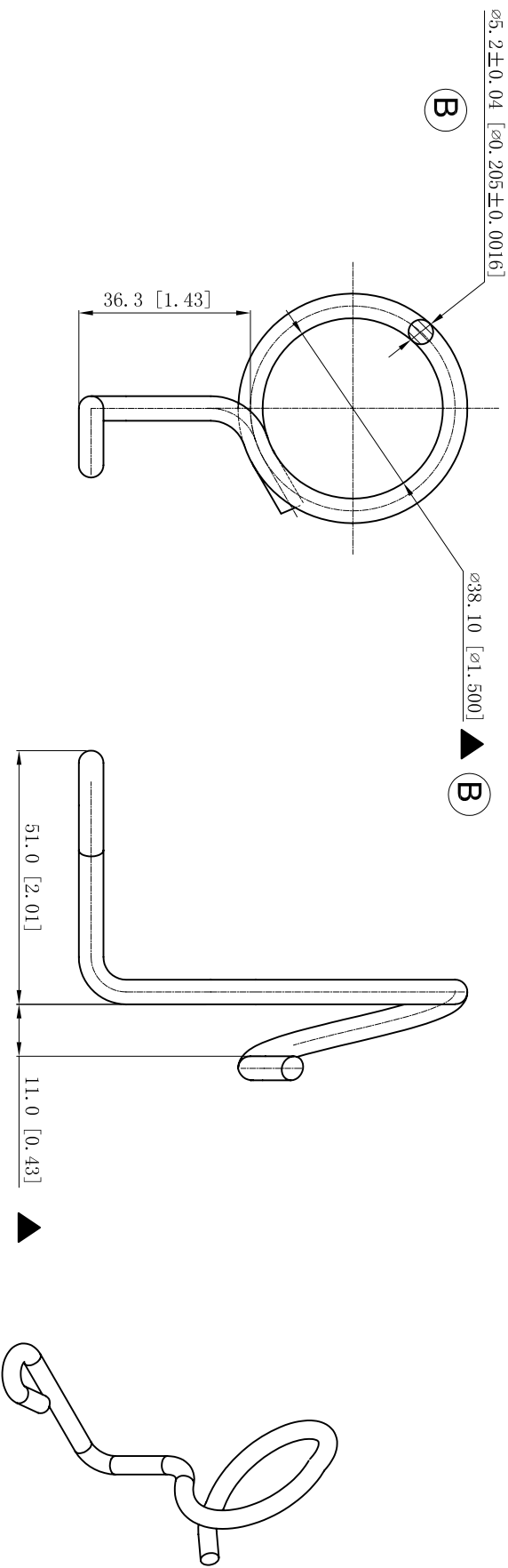

This data sheet is for reference only. GARVIN INDUSTRIES reserves the right to make changes to the design without prior notice.

DESCRIPTION		STANDARD PACKING		TITLE	
Patent #: Pat. US 6,364,266 B1		100 PCS		GARVIN INDUSTRIES	
TRADE REFERENCE TERMS		100 PCS		QUICK-SCREW BRIDLE RINGS	
				SIZE A4	
				DWG NO. BR-150NP	
				DATA SHEET	
				REV C	