

Drop bracket clamp for steady arms, complete, 2 steady arm, to pipe 2.0"

Item number D3138-02

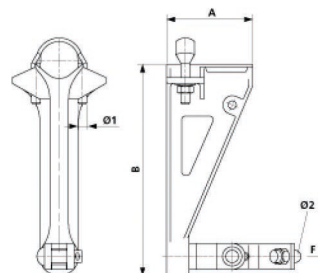

Dimensions

B: 285 mm
A: 115 mm
 $\varnothing 2$: 12 mm
 $\varnothing 1$: M12

Material and weight

Weight: 1.950 kg
Material: Al/SST

Loads

Breaking load F: 11.3 kN



Southwire™



A COLAS RAIL COMPANY

Contact Us: Transit@southwire.com