

SIDES	BOTTOM
1 PCS #10-32×1/2 Screws Installed	
Material:Steel-0.0625"-C. R. S Galvanized	

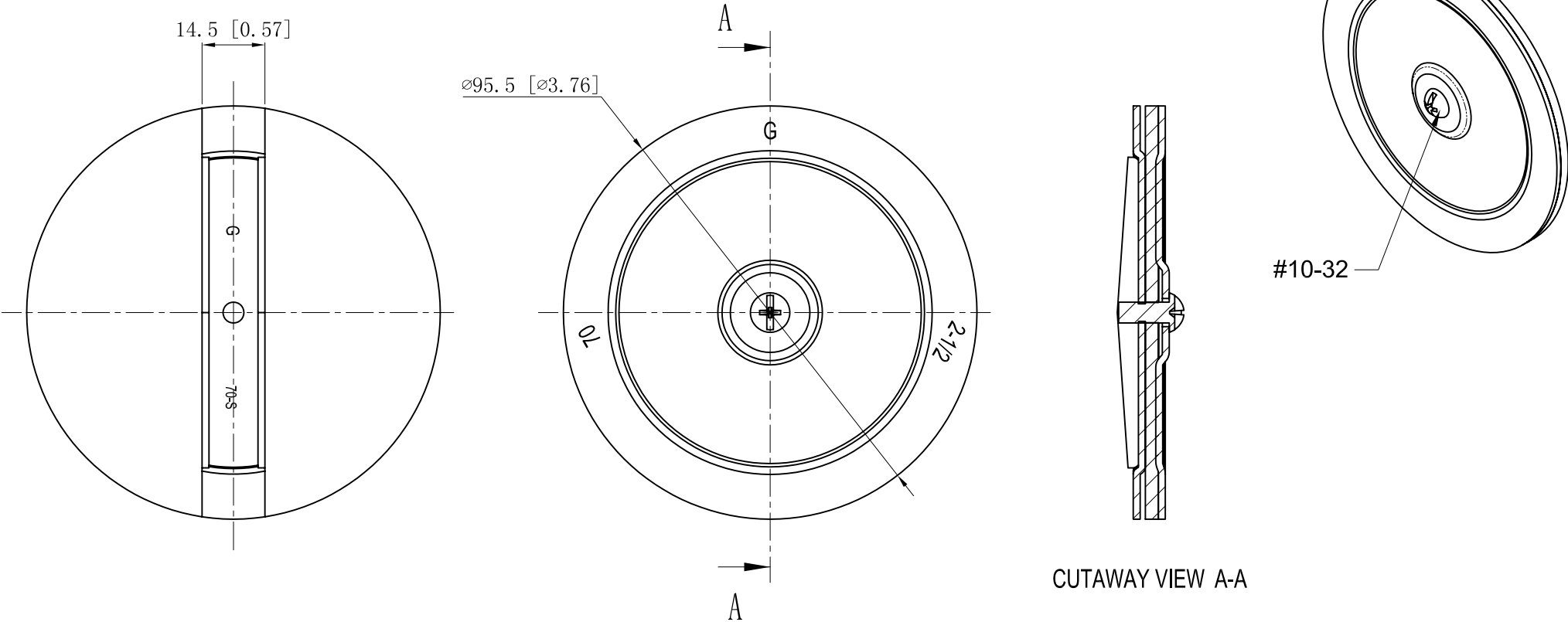

DESCRIPTION
TRADE REFERENCE TERMS

This data sheet is for reference only .GARVIN INDUSTRIES reserves the right to make changes to the design without prior notice.			
STANDARD PACKING	GARVIN INDUSTRIES		
	TITLE KNOCKOUT SEALS		
	SIZE A4	DWG NO. KOS-250-VT	REV
5 PCS	DATA SHEET		