

LED T8 ECO TYPE DIRECT REPLACEMENT

INSTALLATION GUIDE

L4T8E/8xx/13F/ECO-70

General Safety Information

READ AND FOLLOW ALL SAFETY INSTRUCTIONS

DANGER – RISK OF SHOCK – DISCONNECT POWER BEFORE INSTALLATION

CAUTION – RISK OF FIRE. DO NOT INSTALL THIS LAMP IN A PRE-HEAT LUMINAIRE.

CAUTION – RISK OF FIRE. USE ONLY PLACE OF FLUORESCENT LAMPS SPECIFIED ON LABEL.



THIS LAMP ONLY OPERATES ON ELECTRONIC BALLASTS. IF LAMP DOES NOT LIGHT WHEN THE LUMINAIRE IS ENERGIZED, REMOVE LAMP FROM LUMINAIRE AND CONTACT LAMP MANUFACTURER OR QUALIFIED ELECTRICIAN.

DIRECT REPLACEMENT FOR THE FOLLOWING LAMPS ONLY 4ft MEDIUM BI-PIN T8 FLUORESCENT LAMPS 32W/48T8, 30W/48T8, 28W/48T8, 25W/48T8

CAUTION - RISK OF FIRE. IF THE LAMP OR LUMINAIRE EXHIBITS UNDESIRABLE OPERATION (BUZZING, FLICKERING, ETC.), IMMEDIATELY TURN OFF POWER, REMOVE LAMP FROM LUMINAIRE AND CONTACT MANUFACTURER.

SUITABLE FOR DAMP LOCATIONS.

THIS DEVICE IS NOT INTENDED FOR USE WITH EMERGENCY EXITS.

Installation Instructions

1. Turn off the power to the luminaire. **(Fig. 1)**

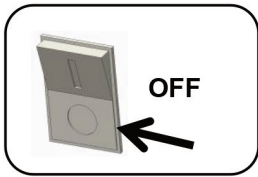

Fig. 1

2. Remove diffuser (if provided).
3. Remove the existing fluorescent lamps from the luminaire. Verify the fluorescent tube type is listed on the label of LED T8 DirectFit lamp. **(Fig. 2)**
4. Dispose the existing fluorescent lamps in accordance with government regulations in your area.
5. Install LED T8 DirectFit lamps. Ensure that the pins are firmly seated in the lampholders. **(Fig. 3)**
6. Replace diffuser (if removed in step 2).
7. Switch on power to the luminaire. **(Fig. 4)**

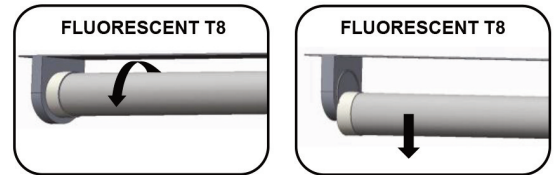

Fig. 2

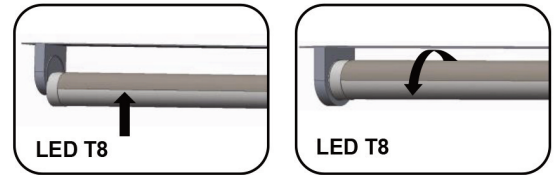

Fig. 3

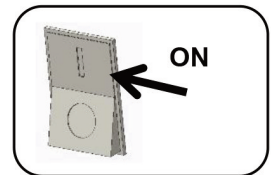

Fig. 4