

SIDES	BOTTOM
Material:Steel-(C1008-C1018) Galvanized	

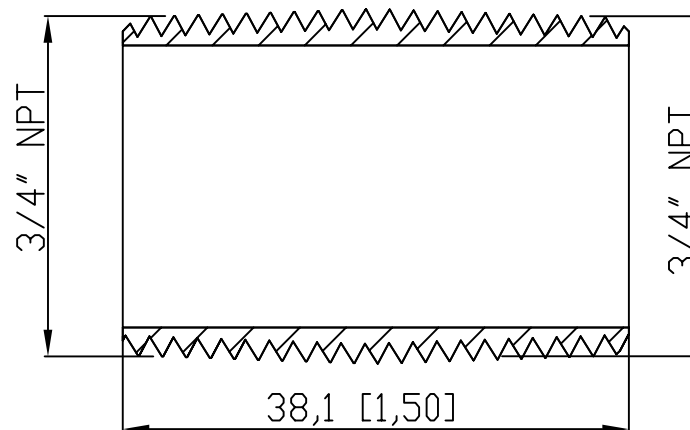
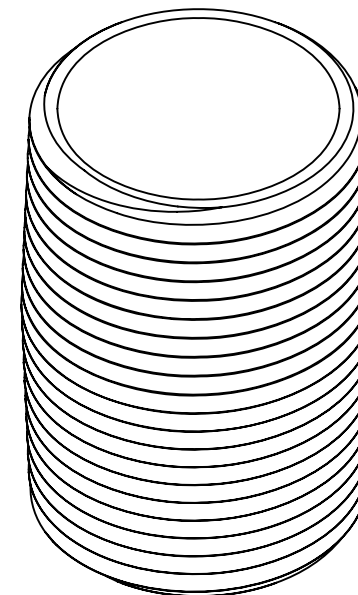
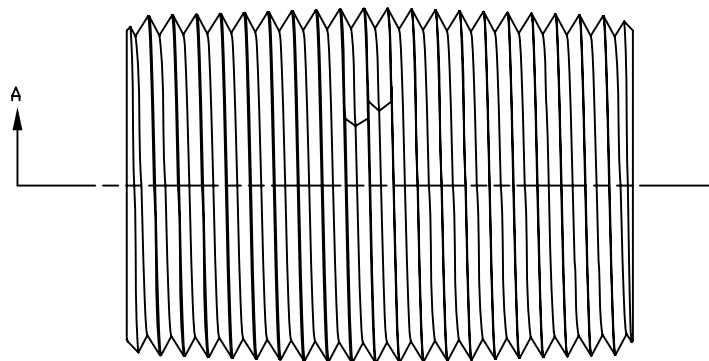

VIEW A-A

DESCRIPTION
TRADE REFERENCE TERMS

This data sheet is for reference only .GARVIN INDUSTRIES reserves the right to make changes to the design without prior notice.

STANDARD PACKING		GARVIN INDUSTRIES	
25 PCS	TITLE RIGID COND NIPPLE		
	SIZE A4	DWG NO. DS-RN-75150	REV A